

# Spot Light

(A)



Suitable for installation in open areas

IP42

(B)



Suitable for installation in escape routes

IP42

(C)



(D)



IP20



The packaging contains: 26 pcs. (A, B, C), 16 pcs. (D)  
Packaging dimensions (LxWxH): 430x375x275mm



## Mounting methods GR-280, GR-298

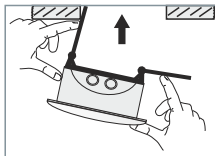

Bend the two springs so that they can pass through the suspended ceiling hole

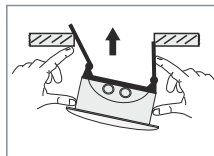

We push the spot luminaire upwards

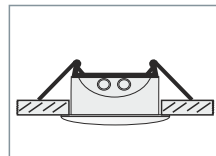

We keep on pushing until the luminaire fits into the hole



The specific luminaire has 2 rim options with perimeter dimensions.

The packaging contains:  
16 pcs. for the: KIT-77/84

Packaging dimensions (LxWxH):  
315x265x205 for the: KIT-77/84

## Dimensions in mm

A, B & C.

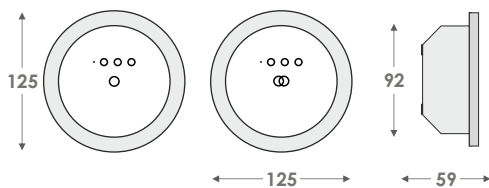

D.

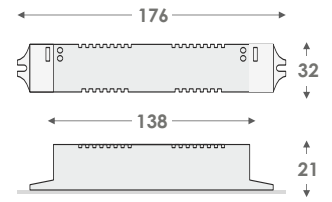
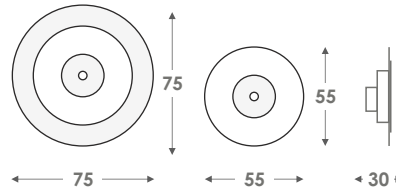

## Photometric data

GR-280, GR-280/24V, GR-290

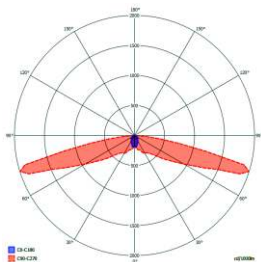

GR-298/30L/180

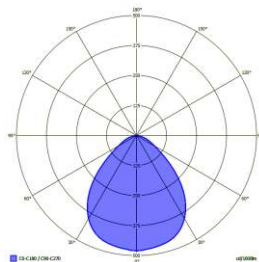

GR-298/60L/90

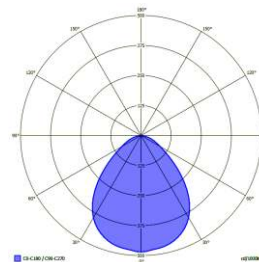



**SELF-TESTING, NON MAINTAINED, CEILING MOUNTED LED EMERGENCY LUMINAIRES**

TYPE	PICTURE	CODE	BATTERY	DURATION	CONSUMPTION	LIGHT OUTPUT	INSTALLATION	GROSS WEIGHT
<b>GR-290</b>	B	923290000	4,8V/1,2Ah Ni-Mh	1,5 h	3,5VA	270 lm	Escape routes	450 gr.
<b>GR-291</b>	A	923291000	4,8V/1,2Ah Ni-Mh	1,5 h	3,5VA	270 lm	Open areas	450 gr.
<b>GR-292</b>	B	923292000	4,8V/1,2Ah Ni-Mh	3 h	3,5VA	150 lm	Escape routes	450 gr.
<b>GR-293</b>	A	923293000	4,8V/1,2Ah Ni-Mh	3 h	3,5VA	150 lm	Open areas	450 gr.

**SET ELECTRONIC BALLAST GR-77 WITH GR-84 NON-MAINTAINED WITH LED 1WATT**

TYPE	PICTURE	CODE	BATTERY	DURATION	CONSUMPTION	LIGHT OUTPUT	GROSS WEIGHT
<b>KIT-77/84</b>	D	923084001	4,8V/1,2Ah Ni-Mh	up to 3 h	6VA	150 lm	310 gr.

**MAINTAINED , CEILING MOUNTED LED EMERGENCY LUMINAIRE**

*When powered with 230VAC the 60 LEDs/250 lm are illuminated whereas during emergency mode the 11LEDs/80lm are illuminated.*

TYPE	PICTURE	CODE	BATTERY	DURATION	CONSUMPTION	LIGHT OUTPUT MAINS/EMERG	GROSS WEIGHT
<b>GR-297/60L/180</b>	C	923297000	4,8V/1,2Ah Ni-Mh	3 h	3,5VA	350/110 lm	533 gr.

**SELF-TESTING, NON MAINTAINED, CEILING MOUNTED LED EMERGENCY LUMINAIRES**

TYPE	PICTURE	CODE	BATTERY	DURATION	CONSUMPTION	LIGHT OUTPUT	GROSS WEIGHT
<b>GR-298/30L/180</b>	C	923298000	4,8V/1,2Ah Ni-Mh	3 h	3,5VA	170 lm	530 gr.
<b>GR-298/60L/90</b>	C	923298001	4,8V/1,2Ah Ni-Mh	1,5 h	3,5VA	340 lm	530 gr.